

FULLY AUTOMATIC LASER DICING MACHINE

AL3000



- **Ø300mm Compatible fully automatic laser dicing machine**

Automatically supports a series of processes from water-soluble protective film distribution to laser dicing and cleaning.

- **Laser Grooving Process compatible**

AL3000 supports applications for removing TEG on low-k grooves or streets.

- **Achieves both high quality processing and high throughput with a unique laser engine mechanism**

- **Enhanced ease of use**

Intuitive operation is possible using the LCD touch panel and simpler screen configuration and iconization by GUI (Graphical User Interface).

TOKYO SEIMITSU CO., LTD.

Laser Grooving process

1 Protection film coating process

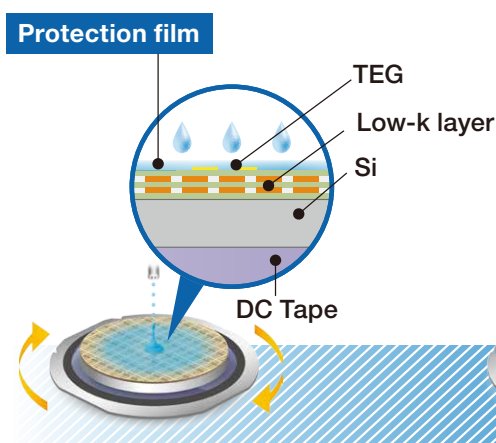

2 Laser Grooving process

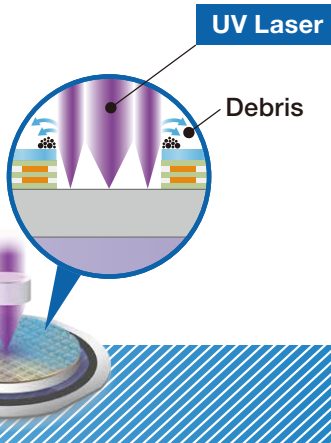

3 Spinner cleaning process

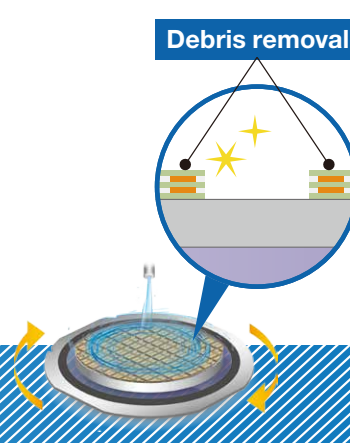

Specifications

Model Name	AL3000	
Processing method	Ablation	
Laser oscillator	Semiconductor Laser excitation Q-Swith Solid-State Laser	
Wavelength(nm)	355	
Max. workpiece size(mm)	Φ305	
Cutting stroke (mm)	310 x 310	
X-axis	Max. Moving speed(mm/sec)	1,000
Y-axis	Max. Moving speed(mm/sec)	300
	Positioning accuracy (μm)	0.078
Z-axis	Max. Moving speed(mm/sec)	10
	Repeatability accuracy (μm)	1.0
θ-axis	Max. rotating angle(deg)	380.0

Power supply(V)	3-phase 200 ~ 220VAC±10% 50/60Hz (380, and 415 V are available with optional transformer)
Power consumption(kVA)	2.0 (Reference values)
Air supply pressure(MPa)	0.5 ~ 0.7
Average air consumption(L/min)	400
N2 supply pressure(MPa)	0.3 ~ 0.5
N2 average consumption(L/min)	30
DI water supply pressure(MPa)	0.3 ~ 0.5
Maximum DI water consumption flow rate(L/min)	6.0
Exhaust (m3/min)	4.0 or more
Dimensions WxDxH (mm)	1,645 x 1,680 x 1,800
Machine weight (kg)	2,500

*In addition to the above, a chiller unit and dust collector are included as ancillary equipment.

External View

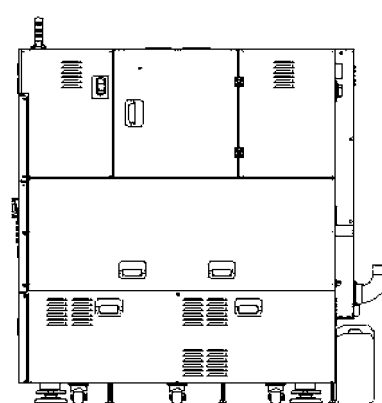
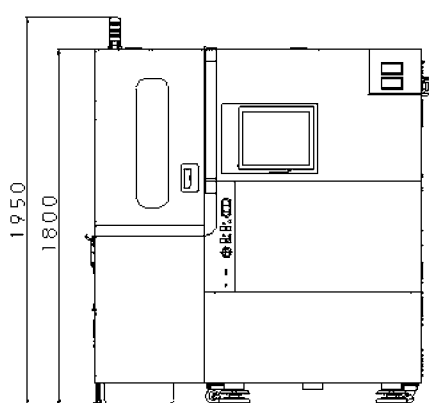
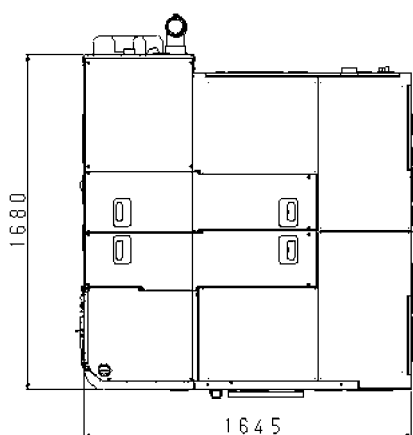

ACCRETECH

Japan / Head Office Tokyo Seimitsu Co., Ltd.
2968-2, Ishikawa-machi, Hachioji-shi, Tokyo, 192-8515 Japan
TEL: (042) 642-1701 FAX: (042) 642-1798
<https://www.accretech.com/en/>

Contact information



● We reserve the right to change the contents of this catalog, including product specifications, without prior notice for improvements in products.

C-92-1122-E-2410